

How to Order

NBV

NATMAN VALVE TYPE  
DESIGNATOR

D

END CONNECTION  
DESIGNATOR

- D: D-LOK TUBE FITTING  
- F: FEMALE PIPE THREAD

8T

SIZE DESIGNATOR

ST

HANDLE  
DESIGNATOR

- ST: STANDARD LEVER  
HANDLE  
- B: OPTIONAL  
BUTTERFLY HANDLE

S

BODY MATERIAL

- S: SS316  
- B: Brass

NPT(ISO/BSP)					
Thread(In)	1/4	3/8	1/2	3/4	1
Designator	4N(R)	6N(R)	8N(R)	12N(R)	16N(R)

Tube									
Fractional Tube	O.D.(In.)	1/4	5/16	3/8	1/2	5/8	3/4	7/8	1
	Designator	4T	5T	6T	8T	10T	12T	14T	16T
Metric Tube	Q.D.(mm)	6	8	10	12	15	16	22	25
	Designator	6M	8M	10M	12M	15M	16M	22M	25M

Factory Testing

Every NATMAN 100 Series Ball valve is adjusted for factory testing at 1000 psig (69 bar) with nitrogen.  
Seat tests have a maximum allowable leak rate of 0.1 std cm<sup>3</sup>/min  
The packing is tested with nitrogen for no detectable leakage.

Cleaning and Packaging

All valves are cleaned and packaged in accordance with D-Lok standard cleaning and packaging procedures.

Pressure-Temperature Ratings

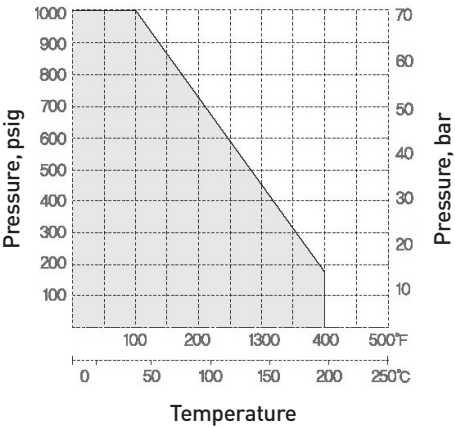

Safety in Valve Selection

Selections of valve function and rating, proper installation, material compatibility, operation and maintenance of these valves are the responsibility of the user.

The system design, application must be taken into consideration to ensure optimal performance and safety.  
We accept no liability for any improper selection, installation, operation or maintenance.

**NATMAN**  
**BALL  
VALVES**  
**2-WAY 100 SERIES**

For working pressure up to 1000 psig (69 bar)  
For use with 1/4"~1" tube and piping system



Design Feature

- Compact design with one piece hexagon body construction.
- 2-way straight pattern.
- Free floating ball design provides seat wear compensation.
- Micro-finished ball provides a leak-tight seal.
- Positive and safe handle stop.
- Low operating torques with stainless steel lever handle.
- Provide quick 1/4 turn on-off control.
- Color coated stainless steel lever handle.
- Handle indicate flow direction.
- Various end connections.

Application

- Fuel Lines, Refineries Chemical Plants, Steel Mills, Heavy Vehicles.

Materials of construction

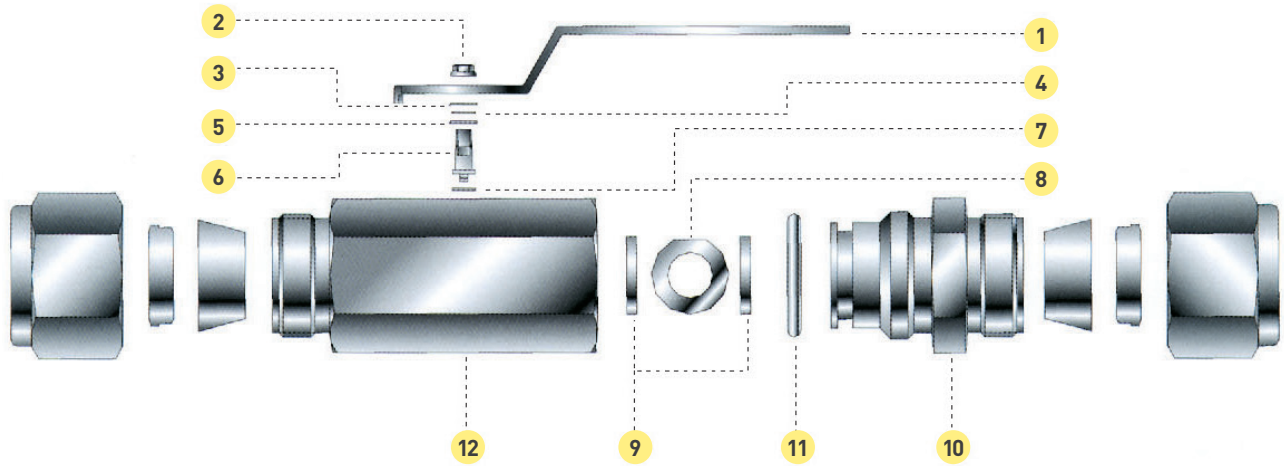

Item	Part Description	Materials of construction	
		Stainless Steel	Brass
1	Handle	SS304	
2	Lock Nut	SS304	
3	Washer	SS304	
4	Washer	SS304	
5	Outer Packing	Reinforced PTFE	
6	Stem	SS316	
7	Inner Packhg	Reinforced PTFE	
8	Ball	SS316	
9	Seat Ring	Reinforced PIPE	
10	End Connector	SS316	Brass / B16
11	O-Ring	NBR	
12	Body	SS316	Brass / B16

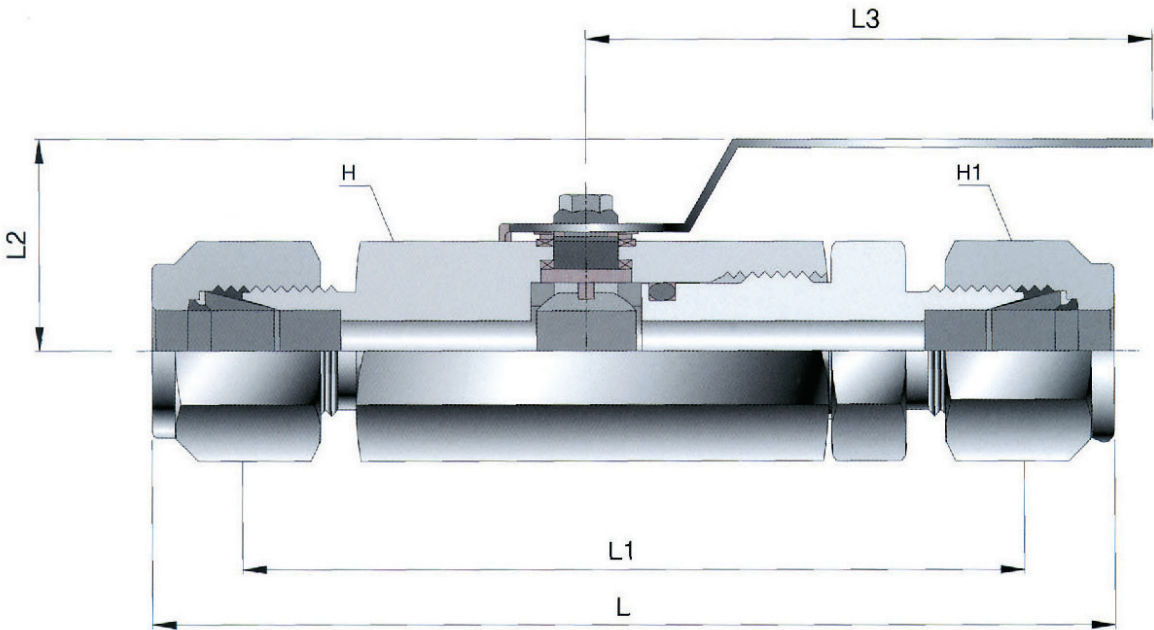

Ordering Information and Table of Dimensions

Basic Pari No.	End Connections	Dimensions (mm)					Orifice (mm)	Weight (Kg)
	Both ends	L	L1	H	H1	L2		
NBVD-6M	6mm D-LOK	79.5	31.0	17.4	14.2	60	5.0	0.14
NBVD-4T	1/4" D-LOK	79.5						0.14
NBVF-4N	1/4" FEMALE NPT	40						0.07
NBVD-10M	10mm O-LOK	90	40.0	22.2	17.4	80	7.5	0.23
NBVD-6T	3/8" D-LOK	90						0.23
NBVF-6N	3/8" FEMALE NPT	45						0.14
NBVD-12M	12mm O-LOK	99	42.0	26.9	22.2	80	9.0	0.36
NBVD-8T	1/2" D-LOK	99						0.36
NBVF-8N	1/2" FEMALE NPT	54.5						0.22
NBVD-16M	16mm D-LOK	109	51.0	31.7	28.5	100	12.5	0.51
NEWD-10T	5/8" D-LOK	109						0.51
NBVF 12N	3/4" FEMALE NPT	61						0.34
NBVD-12T	3/4" FEMALE NPT	110	55.0	38.0	38.0	100	16.0	0.57
NBVD-16T	1" D-LDK	134						0.87
NBVF-16N	1" FEMALE NPT	75						0.62

\* All dimensions shown are for reference purposes only, are subject to change.